

SHILAT Pervolia 1

Pervolia 1
BROCHURE
2026

PROJECT GUIDE



CONTACT INFORMATION

Phone: +357 95703352, +357 95703369

Project Location: Persefonis, Perivolia, Larnaca 7560
Company Name: SHILAT Development

שיווק ומכירות
טלפון: +972524518888

Welcome

WHY CHOOSE US?

This development is our contribution to that shift. A small collection of considered homes, designed for the next chapter of life on the Cyprus coast. We would be glad to welcome you in.



TRUSTED ADVISORS

EXPERTISE CAN TRUST

We have built this with the long view in mind. The kind of home that ages well. The kind of building that, twenty years from now, will still feel as considered as it does the day the keys are handed over. The kind of place that does not just hold its value, but quietly grows into it.

For the people who choose to live here, we hope it offers something rare and increasingly precious: a home that does not need to prove itself. One that simply is — and that, by being so, becomes the setting for a life lived a little more beautifully.



Floor	Unit No	Internal Area (sq.m.)	Number of Bedrooms	Number of Bathrooms	Covered Verandas (sq.m.)	Roof Garden (sq.m.)	Shower Room (Roof Garden) (sq.m.)	Mechanical Room (Roof Garden) (sq.m.)	Storage (Roof Garden) (sq.m.)	Roof Garden Terrace (sq.m.)	Parking (sq.m.)	Parking Number	Ground Floor Storage (sq.m.)	Ground Floor Storage Number	
First Floor	Flat 101	46.90	1	1	6.50	-	-	-	-	-	11.52	P101	-	S101	64.92
	Flat 102	70.00	2	2	17.00	-	-	-	-	-	11.52	P102	-	S102	98.52
	Flat 103	70.00	2	2	15.30	-	-	-	-	-	11.52	P103	-	S103	96.82
	Flat 104	46.30	1	1	15.80	-	-	-	-	-	11.52	P104	-	S104	73.62
	Common	18.30	-	-	-	-	-	-	-	-	-	-	-	-	-
Second Floor	Flat 201	46.90	1	1	6.50	45.39	6.02	-	-	6.18	33.19	P201	-	S201	110.31
	Flat 202	70.00	2	2	17.00	53.16	3.74	3.74	3.60	42.08	11.52	P202	-	S202	151.68
	Flat 203	70.00	2	2	15.30	58.54	3.74	3.74	3.60	47.46	11.52	P203	-	S203	155.36
	Flat 204	46.30	1	1	15.80	58.37	5.68	3.95	3.77	44.97	11.52	P204	-	S204	131.99
	Common	18.30	-	-	-	-	-	-	-	-	-	-	-	-	-

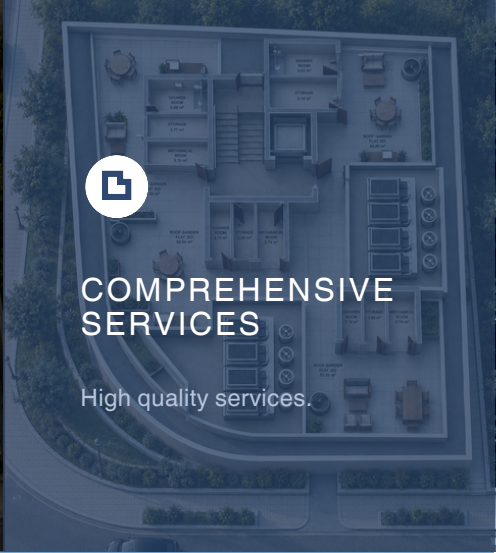
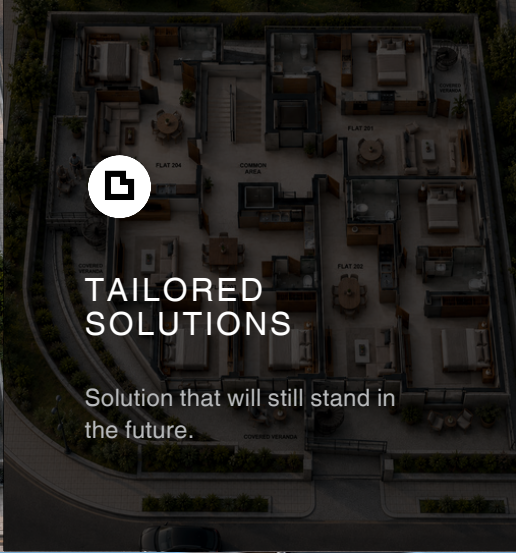

TAILORED SOLUTIONS

Solution that will still stand in the future.



COMPREHENSIVE SERVICES

High quality services.



UNPARALLELED CUSTOMER CARE SERVICE

The design maintains the same modern character as the rest of the building, with simple finishes, clear access, and a functional central core. This creates a professional and well-structured entrance experience that supports the quality of the residential development.

Beyond functionality, the parking area is integrated into the overall architectural design with clean concrete finishes, organized parking lines, lighting, and surrounding landscaping. This ensures the ground level remains visually neat, efficient, and suitable for daily residential use.

STATEMENT

With the private roof garden areas create a premium outdoor lifestyle experience, offering generous open-air space for relaxation, dining, and leisure. With dedicated terrace zones, seating areas, planting, and practical utility spaces, the roof level is designed to be both beautiful and functional.

EXPERT'S



SHILAT
Development



CONTACT INFORMATION

Phone: +357 95703352, +357 95703369

Project Location: Persefonu, Perivolia, Larnaca 7560
Company Name: SHILAT Development

שיווק ומכירות
טלפון: 972524518888+



KITCHEN:

Every detail is designed to feel both premium and practical, from the wall-mounted TV area with wood paneling to the carefully selected lighting and soft furnishings. The result is a stylish everyday living space that feels modern, peaceful, and highly functional.

OPEN DREAM HOME KITCHEN



DESCRIPTION:

The open-plan kitchen is designed as the heart of the apartment, combining functionality, elegance, and everyday comfort. Warm wood cabinetry, clean stone-style worktops, integrated appliances, and refined black details create a modern Mediterranean atmosphere that feels both luxurious and practical.

Its connection with the dining and living areas allows the space to feel open, bright, and social. Whether used for daily living, hosting guests, or enjoying a quiet evening at home, the kitchen offers a carefully planned layout that maximizes storage, movement, and natural flow.



Staying Cozy

The dining area is positioned within the open-plan layout to create a seamless connection between the kitchen, living room, and covered veranda. Its warm material palette, natural wood furniture, and soft neutral tones give the space a welcoming and refined character.



LIVING ROOM



DINNING AREA:

The dining area is positioned within the open-plan layout to create a seamless connection between the kitchen, living room, and covered veranda. Its warm material palette, natural wood furniture, and soft neutral tones give the space a welcoming and refined character.

Designed for both casual meals and intimate gatherings, the dining area benefits from natural light and easy access to the balcony. This creates a relaxed indoor-outdoor lifestyle, ideal for modern apartment living in Cyprus.

LIVING ROOM:

The living room offers a comfortable and elegant setting, designed with soft neutral fabrics, warm wooden finishes, and modern architectural details. Large sliding doors bring natural light into the space, enhancing the sense of openness and creating a bright, calm interior environment. Every detail is designed to feel both premium and practical, from the wall-mounted TV area with wood paneling to the carefully selected lighting and soft furnishings. The result is a stylish everyday living space that feels modern, peaceful, and highly functional.



DINING AREA
LIVING ROOM



COZY BEDROOM

Natural materials, soft lighting, and neutral finishes create a comfortable and adaptable space. Whether used daily or occasionally, the room adds real value to the apartment by offering functionality without compromising on style.



LUXURY BEDROOM



The bedroom is designed as a private retreat, combining comfort, simplicity, and refined materials. Soft beige tones, warm wooden wardrobes, elegant lighting, and carefully selected textures create a relaxing atmosphere ideal for rest and privacy.

Large openings and access to the veranda in selected rooms bring natural light into the bedroom while maintaining a calm and intimate feel. The layout is practical and efficient, offering comfortable sleeping space, built-in storage, and a premium residential character.



BATHROOM

The bathroom is designed with a modern spa-inspired approach, using soft stone-effect tiles, warm wood vanity units, black fixtures, and elegant lighting. The walk-in shower with glass partition creates a clean and spacious feeling, while the wall-mounted sanitary ware adds to the contemporary look.

Every element is selected to provide comfort, durability, and a premium finish. From the illuminated mirror to the practical storage and refined material combinations, the bathroom delivers a calm and sophisticated experience for everyday use.

DETAILS:

The bathrooms are designed with a clean and modern style, using soft neutral tiles, warm wood details, and black fixtures for a refined finish. The layout is practical and comfortable, offering everything needed for daily use while keeping the space elegant and easy to maintain.

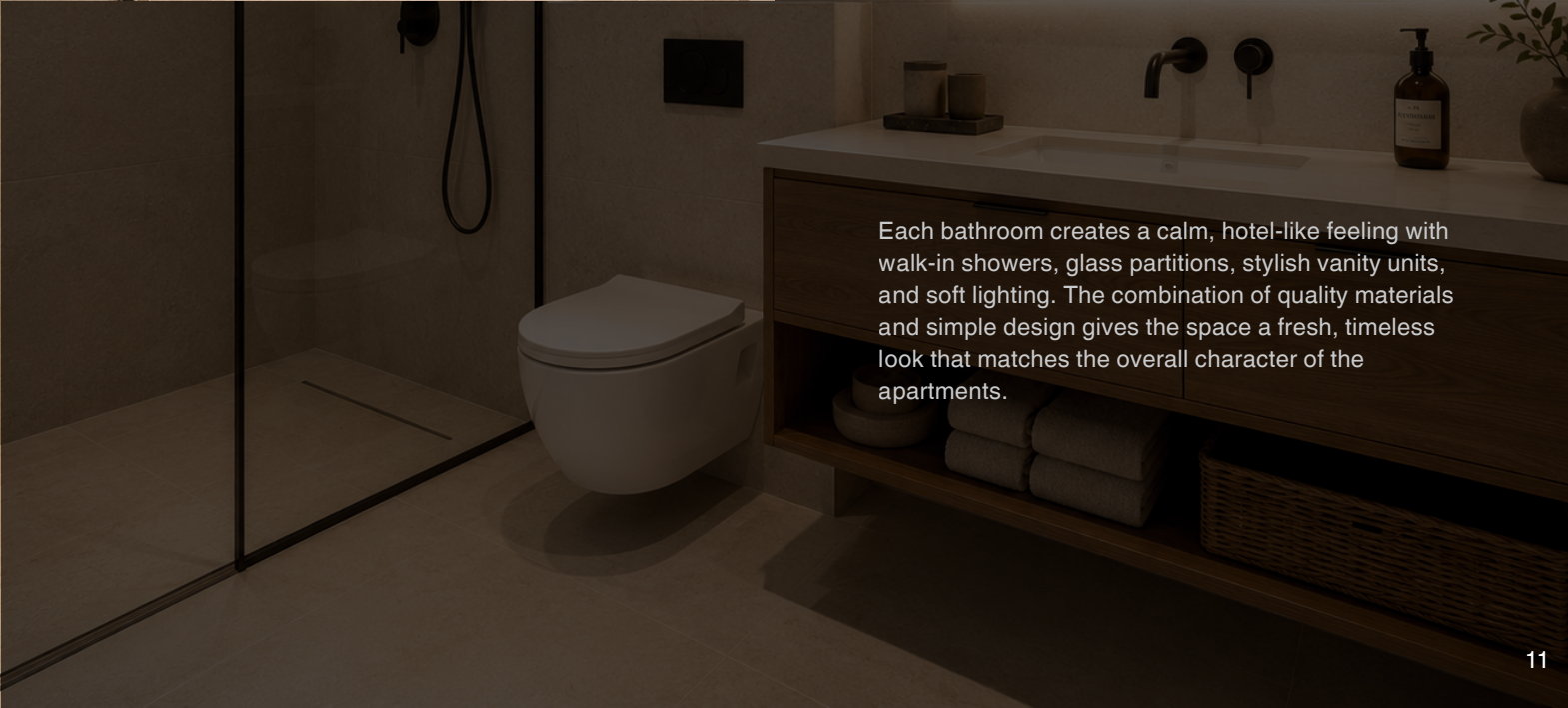

Each bathroom creates a calm, hotel-like feeling with walk-in showers, glass partitions, stylish vanity units, and soft lighting. The combination of quality materials and simple design gives the space a fresh, timeless look that matches the overall character of the apartments.



CONTACT INFORMATION

Phone: +357 95703352, +357 95703369

Project Location: Persefonu, Perivolia, Larnaca 7560
Company Name: SHILAT Development

שיווק ומכירות
טלפון: +972524518888